



Driving  
**TECHNOLOGICAL**  
EXCELLENCE

**HYDRAULIC PRESSURE  
SENSOR**

- ▶ **Single pressure sensor (SPS)** also called as a Pressure sensing pilot valve is used to actuate (Block & Bleed) the flow of hydraulic pilot signal line based on the corresponding process line's pressure which can be used either for High or Low alarm/shutdown based on the application requirement.
- ▶ **Dual pressure sensor (DPS)** is a three-way block and bleed valve capable to Sense dual pressures (high & low) on a Single process connection. It can allow the hydraulic signal flow from inlet port to outlet port when the process line pressure within the set pressure range (normal operation). When the Process line pressure reached the set pressure either Low or High, then the signal line pressure dropped by draining the hydraulic oil from the outlet port to the bleed port.

## FEATURE

- ▶ 3 way 2 Position block and bleed valve capable to Sense pressure.
- ▶ Minimum dead band between trip and reset pressure.
- ▶ Standard 316L stainless steel construction.
- ▶ Set point Repeatability  $\pm 1\%$
- ▶ Process wetted parts in Inconel material as an option.
- ▶ Standard Flow Cv 0.03 (Dead Band ~ 5% @ Max. Set Point)
- ▶ High Flow Cv 0.09 (Dead Band ~ 10% @ Max. Set Point)
- ▶ Vent provided above sensing piston which prevents high pressure process fluid entering the signal line in case of piston seal leak developed.

PART LIST SINGLE PRESSURE SENSOR		
ITEM.NO	DESCRIPTION	MATERIAL SPECIFICATION
1	PISTON HOUSING	SS316 / SS316L
2	PISTON	SS316 / SS316L
3	BODY	SS316 / SS316L
4	PISTON O-RING	VITON
5	SPOOL	17 - 4 PH
6	O RING	VITON
7	SPRING SEATING	SS316 / SS316L
8	SPRING	SPRING - STEEL
9	CAP	S31803
10	LOCK RING	S31803

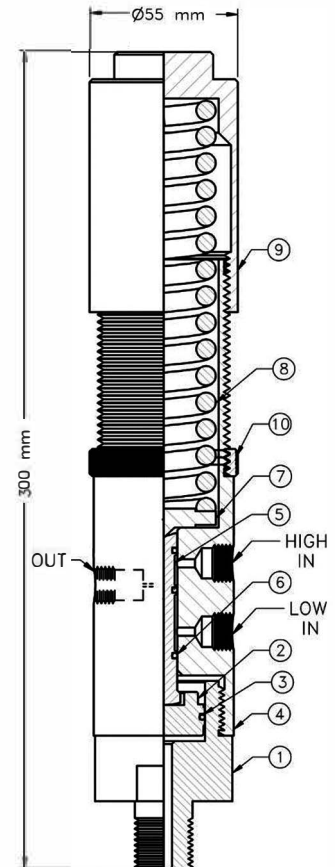

TECHNICAL DATA			
ITEM.NO	DESCRIPTION	SINGLE PRESSURE	DUAL PRESSURE
1	VALVE TYPE	3 - WAY	3 - WAY
2	LOW SET PRESSURE RANGE	10 - 35 Bar.g	2 - 100 Bar.g
3	HIGH SET PRESSURE RANGE	100 - 300 Bar.g	100 - 300 Bar.g
4	MAX. INSTRUMENT PRESSURE	12 BAR	12 BAR
5	CV FACTOR	0.07	0.09
6	SENSOR TYPE	PISTON	PISTON
7	MOC	SS316L/ Duplex SS / Inconel	SS316L/ Duplex SS / Inconel

- WETTED PARTS AVAILABLE IN INCONEL ALSO SPRING AVAILABLE IN INCONEL X - 750 AND OTHER ALTERNATE MATERIALS AS PER CUSTOMER REQUIREMENT

PART LIST DUAL PRESSURE SENSOR		
ITEM.NO	PART DESCRIPTION	MATERIAL SPECIFICATION
1	BODY HOUSING	SS 316 / 316L
2	PISTON HOUSING	SS 316 / INCONEL 625
3	PISTON	SS 316 / INCONEL 625
4	L.P ACTUATOR	SS 316 / 316L
5	L.P SPRING	SS 304
6	H.P SPRING	SS 304
7	SPRING COVER	SS316 / 316L
8	H.P TOP PART	SS316 / 316L
9	THRUST PLATE	SS316 / 316L
10	L.P TO PART	SS316 / 316L
11	ADJUSTOR SUPPORT	SS316 / 316L
12	SET SCREW	MS / SS316
13	DOWEL PIN	SS316 / 316L
14	PISTON SEAL	VITON
15	H.P ACTUATOR	SS316 / 316L
16	L.P ACTUATOR	SS316 / 316L
17	PISTON BACKUP RING	PTFE
18	BEARING ASSEMBELY	SS316 / 316L
19	CIRCLIP	SS304 / SS316
20	CAP	SS304 / SS316
21	SPOOL	SS316L / 17-7 PH
22	SPOOL O- RING	VITON

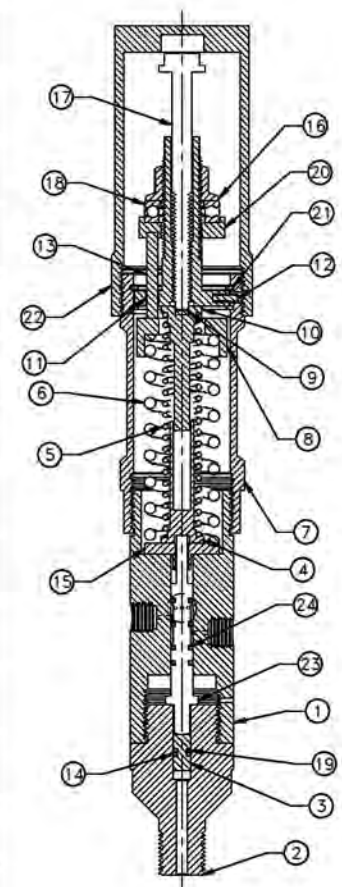

**Note:** Customised models and materials are available based on requirements.

Above data are only for reference purpose and subject to change without any prior notice due to constant efforts on product improvement.



## CONTACT US:



### **PETRONASH ENGINEERING SERVICES PVT LTD**

F- 46 & 47, Bible College Road, 8th Main Road, 3rd Cross,  
SIPCOT Industrial Park, Irungattukottai,  
Sriperumbudur - 602 105, India



**+91-44-66142800**



**irksales@petronash.com**



**+91-44-66142828**



**www.petronashengineering.com**

